

BOTTOM VIEW

* Applicable size of IC package : IC body size 7.0 x 7.0 mm
IC outer size 9.0 x 9.0 mm

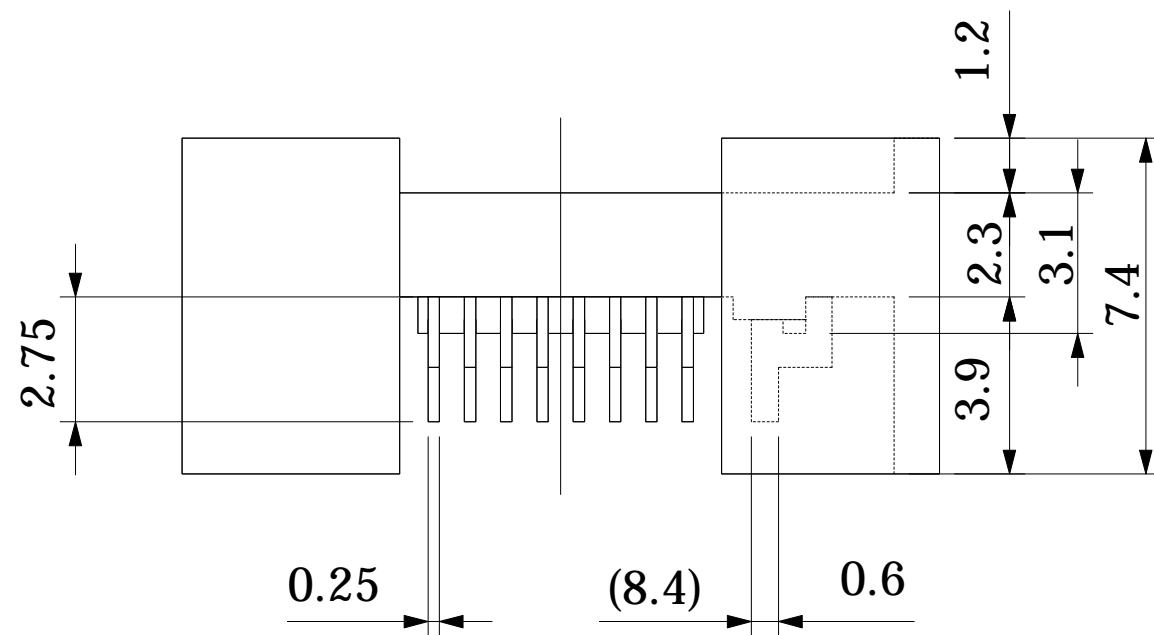

Part No.	HQPACK032SA
IC package	Square
Pin count	32Pin
Lead pitch	0.8mm
Unit : mm	Design : M.H
TET TOKYO ELETECH CORP.	