

\* Applicable size of IC package : IC body size 10.0 x 10.0 mm  
IC outer size 12.0 x 12.0 mm

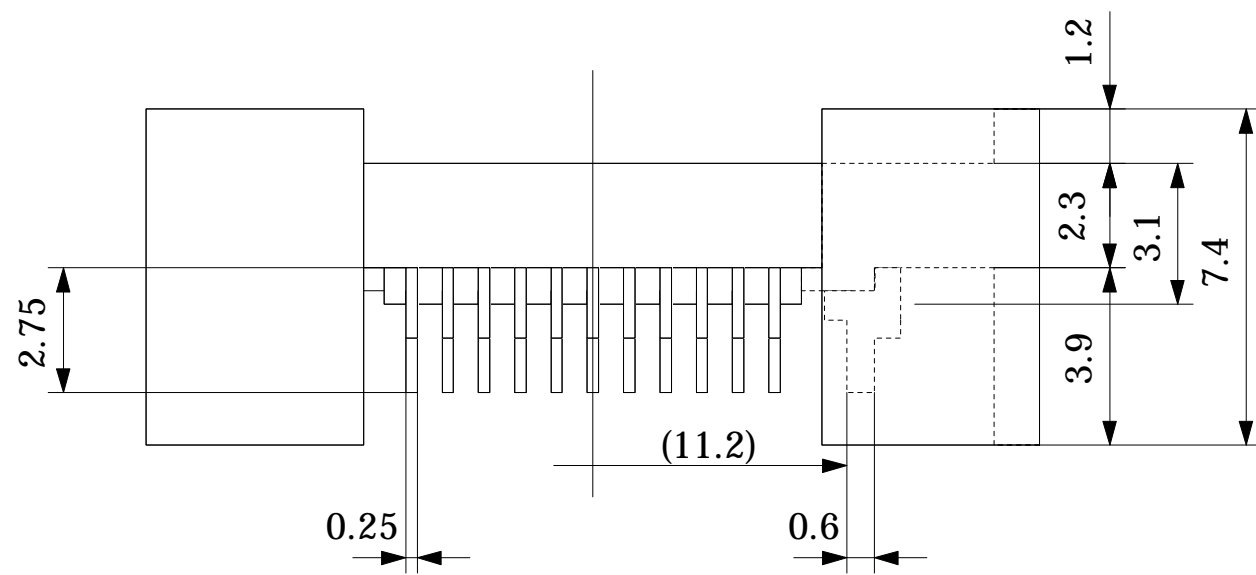

Part No.	<b>HQPACK044SA</b>	
IC package	Square	
Pin count	44Pin	
Lead pitch	0.8mm	
Unit : mm	Design : M.H	
<b>TET</b> TOKYO ELETECH CORP.		